  
Greta Wings

## Contact information

If you have any questions about making this pattern, please don't hesitate to contact me. I'd also love to see your finished amigurumi.

-  linetr2011@gmail.com
-  GretaWings <https://www.instagram.com/gretawings/>
-  GretaWings [https://www.facebook.com/grettawings/?ref=pages\\_you\\_manage](https://www.facebook.com/grettawings/?ref=pages_you_manage)
-  GretaWings <https://www.youtube.com/channel/UCz8UB400yzyr6XS9Ncvy7nA>
-  Greta Wings DIY [https://www.youtube.com/channel/UCr4xjdD89uaRXwKnJb6u7\\_g](https://www.youtube.com/channel/UCr4xjdD89uaRXwKnJb6u7_g)
-  GretaWings <https://gretawings.com/>

## Copyright

This pattern is intended for personal use only. It may not be copied, translated, or distributed in any form.

You can sell the finished product of your amigurumi however you prefer. If you decide to sell your finished product online, please include a link to our website in the description. This way, you'll also be supporting our project.

## Important Note:

This amigurumi is worked with X-shaped and spiral stitches. Do not cast off each row unless indicated; be sure to always mark the beginning of each row. Please read the entire pattern before beginning. We have a tutorial on our channel for making this amigurumi. You can access the links attached to each image if you have any questions. If you find any errors in this pattern, please contact me.





These amigurumi are approximately  
19 cm tall.

#### MATERIALS:

- 100% Mercerized Cotton Yarn (Approx.3mm Thickness): Colors: green(fresh), medium yellow, Nordic blue, olive green, rosewood, dry lavender (purple), white and red
- Hook (Crochet): 2.5 mm
- Articulated Structure: Wire and adhesive tape to protect the tips.
- Wool needle and pins.
- Scissors.
- Synthetic filling.
- Silicone glue (for the base of the feet and details).
- button (only for soda base)
- Black felt for the eyes

#### ABBREVIATIONS:

- R: Round
- ch: chain stitch
- MR: Magic ring
- sc: single crochet
- dec: decrease (close 2 sc together)
- inc: Increase (2sc in 1 stitch)
- dc: double crochet
- tr: treble crochet
- hdc: half double crochet
- ss: Slip stitch
- FLO: Front Loop Only (take only the front strand)
- BLO: Back Loop Only (take only the back strand)

Material on our website

[www.gretawings.com](http://www.gretawings.com)

#### Important note:

This pattern can be adapted to create amigurumi of different sizes with different yarn thicknesses. Adjust the crochet hook size according to the thickness of the yarn selected.

I hope you enjoy designing this pattern as much as I did.



## LEGS (X2)

Start with Fresh Green yarn

R1: MR 6sc

R2: (2sc, 1inc) x 2 (8)

R3: (3sc, 1inc) x 2 (10)

R4: (4sc, 1inc) x 2 (12)

R5-7: 12sc

R8: (4sc, 1dec) x 2 (10)

R9: 10sc

[Link to video](#)

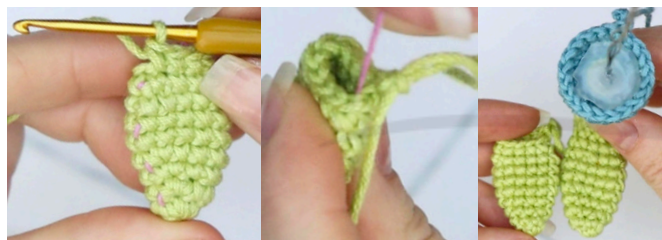

## Notes on Structure and Stability:

- **Wire Preparation:** After completing R9, prepare a piece of wire approximately 44 cm long. Fold it in half and shape it to the form of the foot. We use double-stranded 22-gauge wire because it is thin and we need more strength. Make sure to leave enough excess wire so that the structure can extend around the entire body.
- **Positioning:** Before fixing, check that the start and end of each round are aligned exactly to one side.
- **Silicone Fixing:** Inject a small amount of hot silicone into the base of the foot and press until it cools to achieve a completely flat surface. Important: Avoid getting glue on the R9, as we need to have free space to continue knitting.

- **Stability Tip:** While you can use traditional stuffing, we recommend this method with silicone and wire so your Net Peterson achieves the necessary balance and stands on its own. For a more detailed visual guide, we recommend watching the video tutorial.

[Link to video](#)



R10-12: (FLO 5ss), 5hdc (10)

It is essential that in these rounds you always begin working on the front loops and then on the half double crochets, working them in the usual way. Try to work the half double crochets as tightly as possible.

[Link to video](#)



Tip: To make the legs look as similar as possible, it is recommended to crochet them on the same day, since we don't crochet the same way every day.

[Link to video](#)

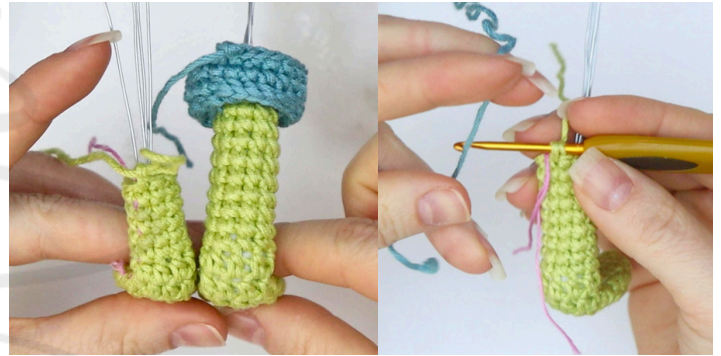

R22: In front 10ss

[Link to video](#)

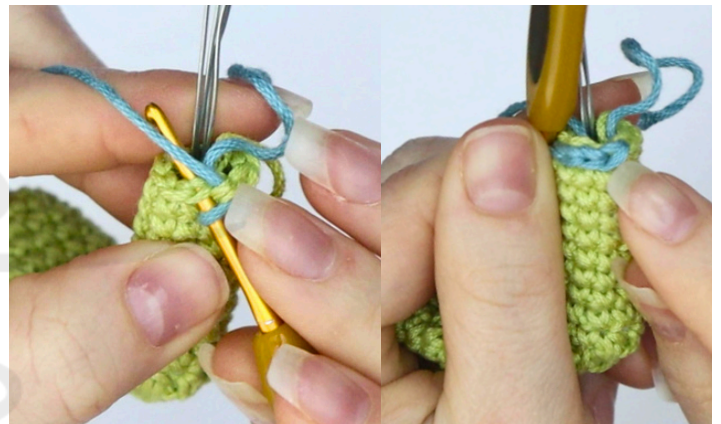

R23: FLO 10 inc (20)

[Link to video](#)

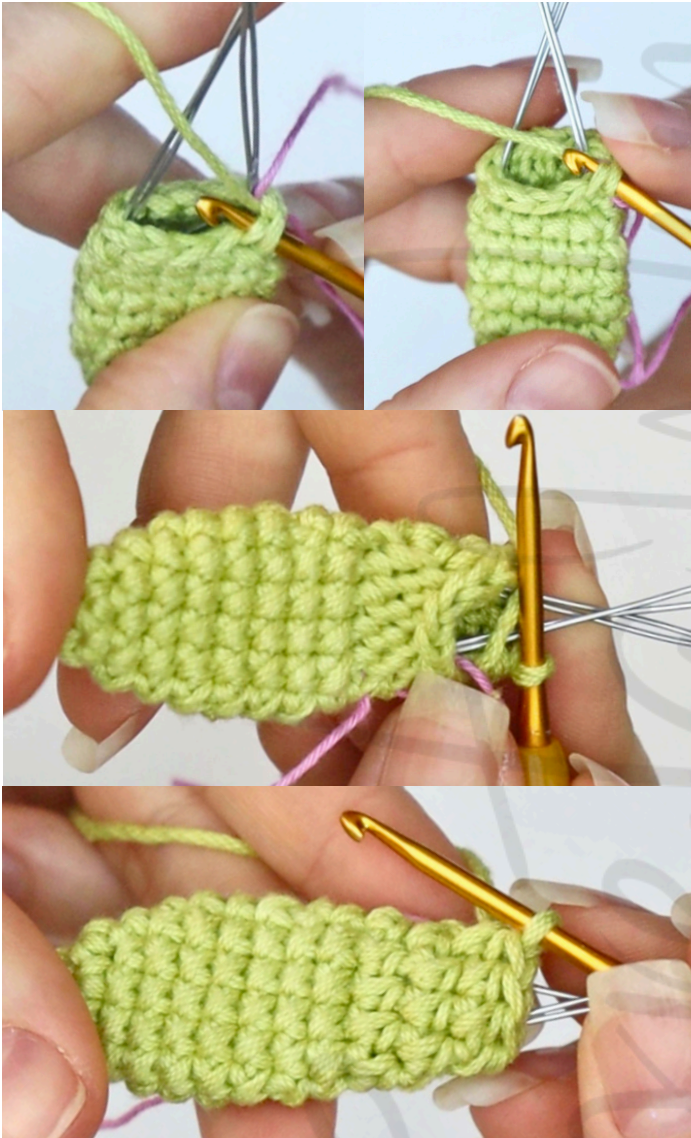
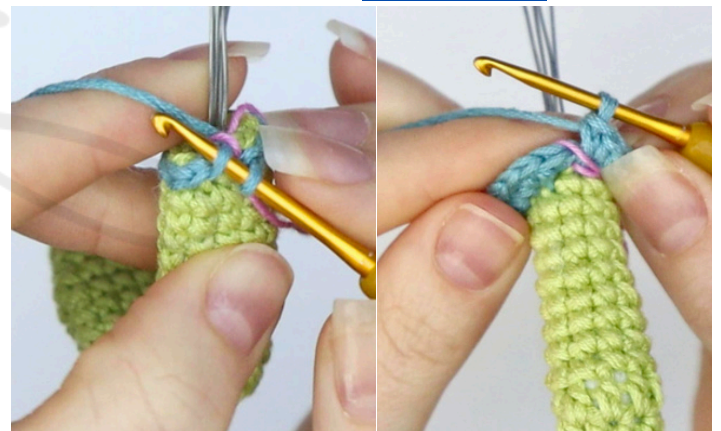

R13-21: 10sc Change to Nordic Blue in the last single crochet of R21.

Fill in as you go with your crocheting and fold the leg as shown in the pictures.



R24: 20 sc reverse [Link to video](#)



[Link to video](#)

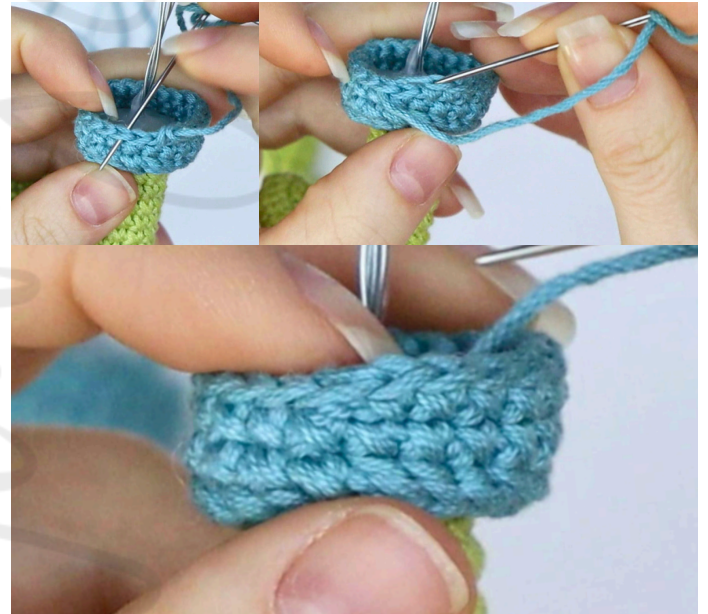

Before joining the pieces, stuff the legs. Optionally, you can apply hot glue to the center to secure the wire and achieve a flatter finish in the shorts area.

[Link to video](#)

R25-26: 20sc [Link to video](#)

#### Technical Finishing Instructions (Legs)

- **First Leg:** After completing Round 26, cut the yarn leaving a small tail and make an invisible join. If you don't know how to do this, don't worry: pass the yarn through a tapestry needle, skip one stitch and go through the next, then return to the center of the last stitch worked to simulate the top chain. This will leave a neat edge for joining.
- **Second Leg:** When you finish R26, do not cut the yarn. Keep the loop on your crochet hook, as from this point we will immediately continue with R27 to join both legs and begin the body of our Net Peterson.



When making R27, use the exact points that I share with you in the pattern. However, if you notice that the legs are not aligned facing forward, you need to adjust the starting points. You will need to find the exact center side of each leg and shift the points as needed to achieve symmetry.

Keep in mind that the position of the stitches varies greatly depending on your technique, especially if you're crocheting with single crochet in an X or V shape, as this changes the natural slant of the fabric. Make sure they're nice and straight before continuing with the body!

[Link to video](#)

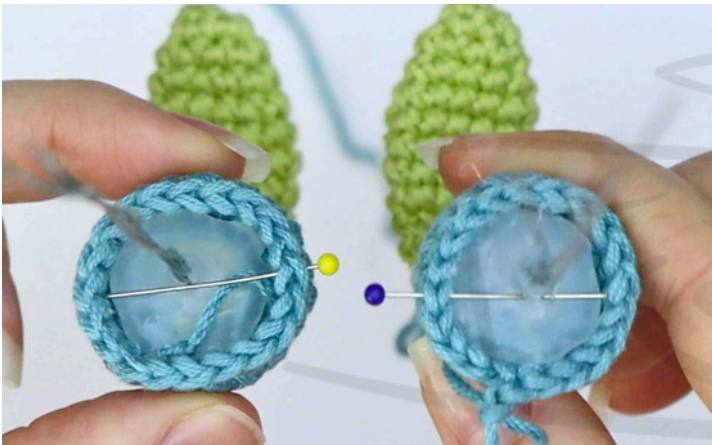

#### UNION

R27: Continue on the 2nd leg 4sc, 1ch, 20sc (on the 1st leg), 1sc in the c, 16sc (on the 2nd leg) (42)



R28 - R33: 42sc

[Link to video](#)

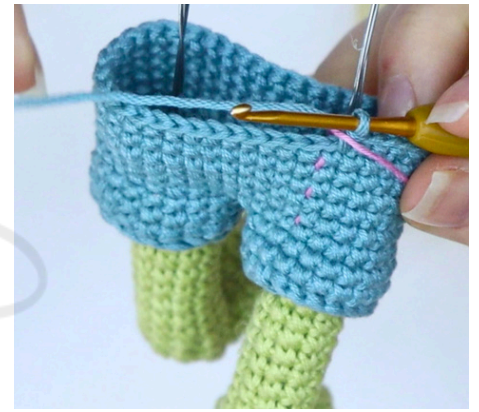

When you finish R33, don't cut the Nordic blue yarn, as we'll use it again; always leave it facing outwards. However, we'll proceed with R35 first.

Begin by inserting the hook as centered as possible at the back of the body. I'll start at the fifth stitch of the previous round, pulling up a loop; however, we'll actually make the first stitch at stitch number six, and then continue to the next one.

[Link to video](#)



R35: BLO Yellow (Y) 16sc, Olive (O) 10sc,  
Y 16sc (42) [Link to video](#)

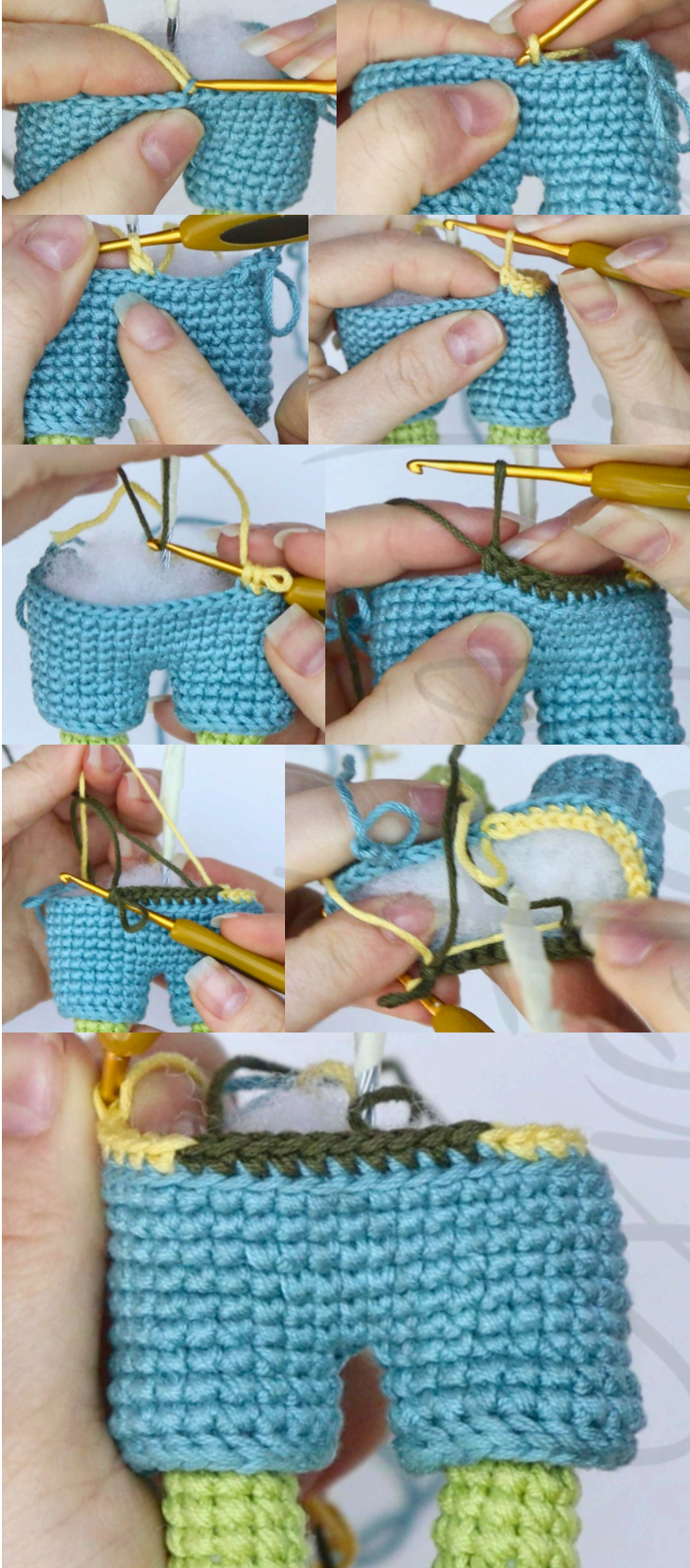

R34: FLO 42sc [Link to video](#)



When finished, cut the thread and make an invisible closure. [Link to video](#)

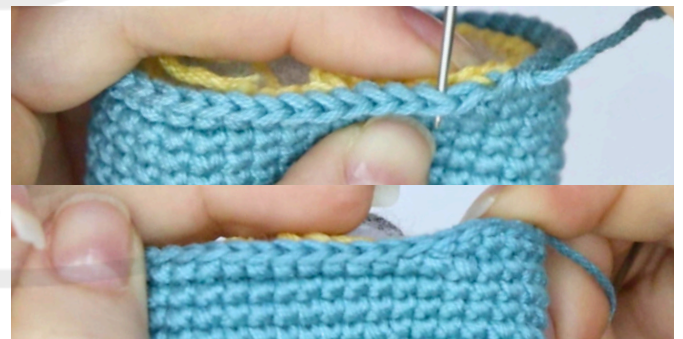

R36 - R43: Y 16sc, O 10sc, Y 16sc (42)

R44: Y 17sc, O 8sc, Y 17sc (42)

R45: Y 18sc, O 6sc, Y 18sc (42)

R46: 42pb [Link to video](#)

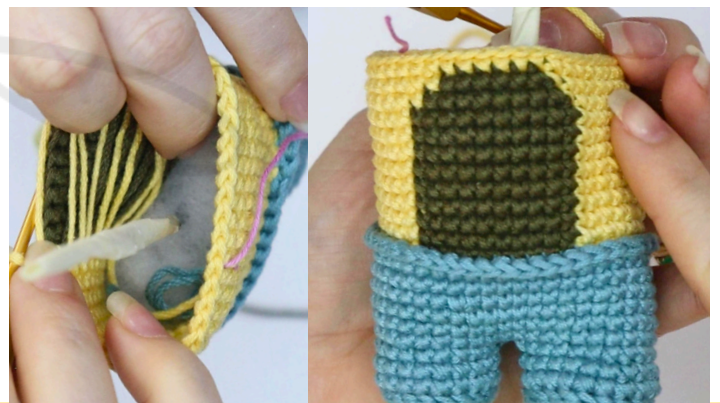

R46: 42sc

R47: (6sc, 1inc) x 6 (48)

R48-R59: 48sc [Link to video](#)



Add the stuffing, making sure the fish looks slimmer in the shorts area. Also, prepare the fins before continuing with the body.

FINS (X2) [Link to video](#)

Use Fresh Green yarn

R1: MR 6sc

R2: (2sc, 1inc) x 2 (8)

R3: (3sc, 1inc) x 2 (10)

R4: (4sc, 1inc) x 2 (12)

R5 - R9: 12sc

After completing R9, add wire and glue to the fin, just as you did previously with the feet. Make sure to use enough wire for the fin, leaving some extra to attach it to the central part of the body.

[Link to video](#)

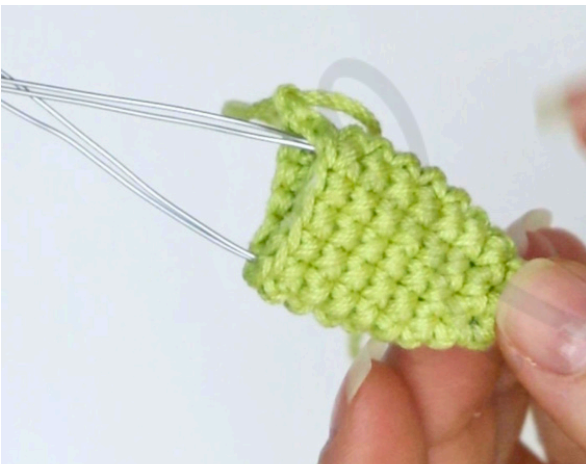

R5 - R9: 12sc

R10: (4sc, 1dec) x 2 (10)

R11 - R13: 10sc

R14: (3sc, 1dec) x 2 (8)

R15 - R17: 8sc

R18: (2sc, 1dec) x 2 (6)

R19 - R22: 6sc



At the end of round 22, cut the yarn, leaving enough length to attach it to the body with a seam. Insert the fin wires between rounds 48 and 49, making sure to leave a 6-stitch gap starting from the rounds where the olive-colored stitches are worked straight. Then, sew this connection for clarity; see the video for more details. [Link to video](#)

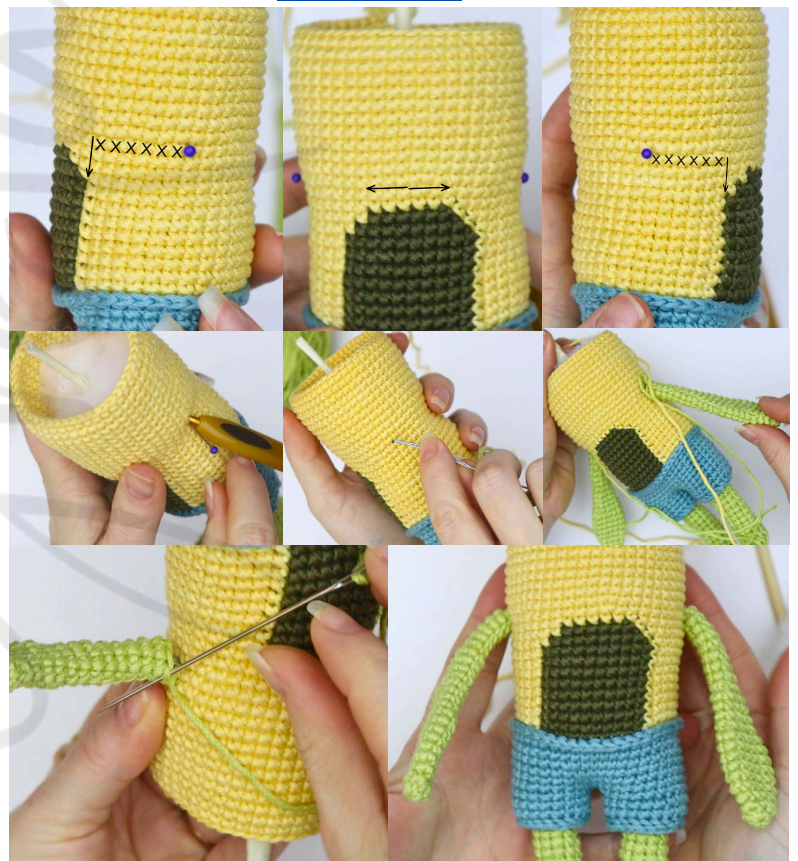



Fill in as you go with your tissue.

[Link to video](#)

R60: (6sc, 1dec) x 6 (42)

R61: 42sc

R62: (5sc, 1dec) x 6 (36)

R63: (4sc, 1dec) x 6 (30)

R64: (3sc, 1dec) x 6 (24)

R65: (2sc, 1dec) x 6 (18)

R66: (1sc, 1dec) x 6 (12)

R67: 12sc

At the end of R67, cut the yarn, leaving enough to close it with a tapestry needle. If you think it's necessary, you can still add more stuffing.

[Link to video](#)



LIPS (X2)

Use rosewood colored yarn

R1: MR 6 sc

R2 - R16: 6 sc

[Link to video](#)

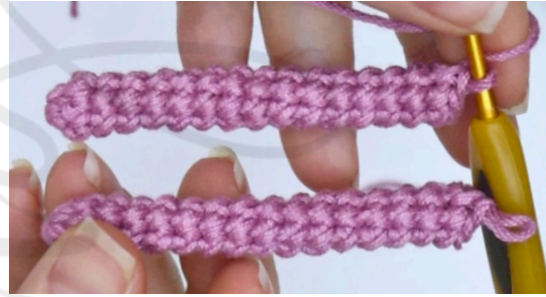

When you finish the first lip, cut the yarn, leaving enough to close it with a tapestry needle. When you finish the second lip, cut the yarn again to close it in the same way; however, before closing it, add a little stuffing to the center of the lip, only in the center. This is optional, but it will give the upper lip a slightly different look; this will be the lower lip.

[Link to video](#)

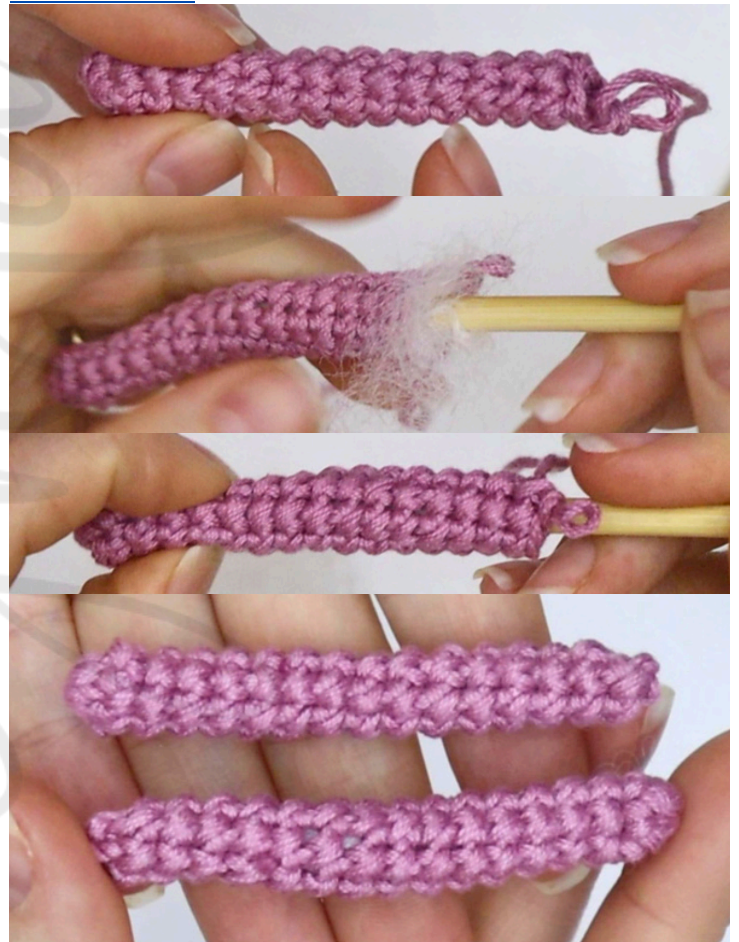



[Link to video](#)



**EYES (X2)**

For each eye, we will make two circular pieces that are then overlapped:

**GREEN PIECE (X2):**

- R1: MR 6sc
- R2: 6 inc (12)
- R3: (5sc, 1inc) x 2 (14)
- R4: 14sc

At the end of R4, cut the yarn leaving enough for an invisible closure.

[Link to video](#)



**WHITE PIECE (X2):**

- R1: MR 6 sc
- R2: 6 inc (12)
- R3 - R4: 12 sc

At the end of R4, stuff lightly to maintain the shape of the eye and close using a tapestry needle.

[Link to video](#)

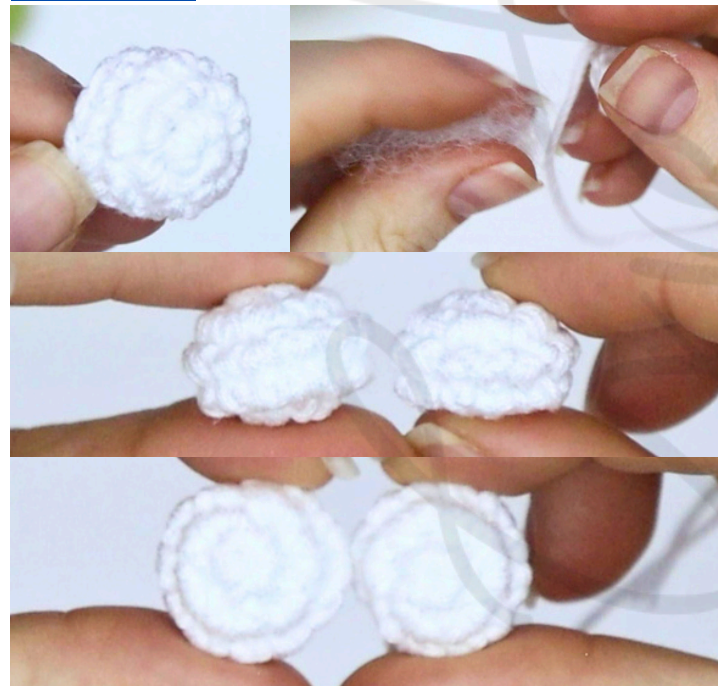

Prepare two pieces of felt; You can use these shapes, as they are the perfect size to cover the entire first round of the MR. Keep in mind that if you use a thicker or thinner yarn, you will need to adjust it. The idea is that the top of the felt will be hidden within the green piece of each eye.

You now have all the pieces ready. Place the filter on the white piece, making sure the beginning and end of each round face upwards. This way, it will be hidden inside the green piece. Then, join the green piece, ensuring the beginning and end of each round face backwards. This way, when we connect it to the body, it will remain hidden.

[Link to video](#)



[Link to video](#)

## REAR FINS

Use dry lavender (purple) colored yarn.

3ch, 1ss, 1sc

4ch, 1ss, 1sc, 1hdc

(5ch, 1ss, 1sc, 1hdc, 1dc)x2

(6ch, 1ss, 1sc, 1hdc, 1dc, 1tr)x4

(5ch, 1ss, 1sc, 1hdc, 1dc)x2

4ch, 1ss, 1sc, 1hdc

3ch, 1ss, 1sc

1ch to secure and cut the thread, leaving enough to hide.

You will fold this piece in half, joining end to end, which will give it firmness. By joining them, you will create a better base to attach to the body later.

[Link to video](#)

R10: BLO 16ss

R11: BLO 16sc [Link to video](#)

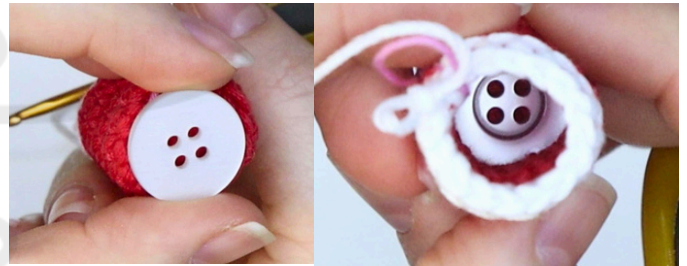

After completing R11, add a flat base to the bottom of the soda bottle. You can use a button or cut out a piece of cardboard; just make sure it's the right size. You can also melt hot glue and wait for it to cool.

[Link to video](#)

R12: 8 Purlwise Decreases (8)

If you have never done purlwise decreases, it is important that you watch the video tutorial here. [Link to video](#)

## SODA

[Link to video](#)

Start with red (strawberry) yarn.

R1: MR 8 sc

R2: 8 inc (16)

R3: BLO 16sc

R4-9: 16 sc.

Change to white yarn in the last sc of Round 9.

Don't forget to add the Filling

R13: (2sc, 1dec) x 2 (6)

R14-R20: 6sc

When finished, cut the yarn leaving enough length to close, but make sure to add the wire first.



Add enough wire to help the straw retain its shape, then close it completely.

[Link to video](#)

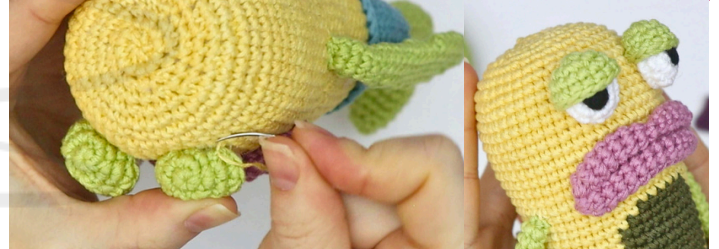

### PUTTING ALL THE PIECES TOGETHER

Let's begin assembling all the parts. Although everything can be glued together, sewing is essential at the ends of each lip. I encourage you to watch the video for a better understanding of each joint.

[Link to video](#)





Attach the base of the rear fins and hide any excess strands. For added safety, make stitches using only two strands of the dry lavender-colored thread.

I glued the soda onto a fin

[Link to video](#)

[Link to video](#)



Congratulations!  
You have  
completed your  
amigurumi.

If you enjoyed our pattern and decide to share your finished project on your social media, don't forget to tag us so we can admire your result. Please remember that this is a paid pattern I've dedicated a lot of time and love to. Out of respect for our project, I kindly ask that you do not share it in groups or online, as this greatly harms us. Even if you've purchased the pattern, please remember that you are acquiring the pattern itself, not the copyright, which belongs to GretaWings.

Thank you!

Once purchased, you are buying the pattern, not the copyright, and the rights to it belong to GretaWings. Thank you.



*GretaWings*