



**Copyright**

This pattern is intended for personal use only. Reproduction, translation or distribution in any form is not permitted.



## Contact information

If you have any questions about making this pattern, please feel free to contact me. I would also love to see your finished amigurumi.

-  linetr2011@gmail.com
-  GretaWings <https://www.instagram.com/gretawings/>
-  GretaWings [https://www.facebook.com/grettawings/?ref=pages\\_you\\_manage](https://www.facebook.com/grettawings/?ref=pages_you_manage)
-  GretaWings <https://www.youtube.com/channel/UCz8UB400yzrx6XS9Ncvy7nA>
-  Greta Wings DIY [https://www.youtube.com/channel/UCr4xjdD89uaRXwKnJb6u7\\_g](https://www.youtube.com/channel/UCr4xjdD89uaRXwKnJb6u7_g)
-  GretaWings <https://gretawings.com/>

## Copyright

This pattern is intended for personal use only. It may not be copied, translated or distributed in any form.

You can sell the final result of your amigurumi in any way you prefer. If you decide to sell your finished item online, please include a link to our website in the description.

This way, you will also be supporting our project.

## Important Note:

This amigurumi is worked with tight V-shaped and spiral stitches. Do not close off each row unless indicated; make sure to always mark the beginning of each row. Please read the entire pattern before starting. We have a tutorial on our channel to make this amigurumi. You can access the links attached to each image if you have any questions. If you find any errors in this pattern, please contact me.



Copyright

In this pattern you will find all the details necessary to make the two magical elves: Elyndra and Lunithiel.

Both share a delicate and charming design, but are differentiated by their colors and unique characteristics:

- Elyndra: This red-haired elf is dressed in warm shades of citrus and tangerine, reflecting the vibrancy of the forest and the charm of autumn leaves.
- Lunithiel: With her platinum hair and dress in soft shades of sky blue and straw (yellow), she evokes the serenity of the sky and starlight.

They both stand approximately 5 inches tall, though this can vary depending on the material you use to crochet them. They will not stand on their own however they are fully articulated.

**Important note: This pattern can be adapted to create amigurumi of different sizes using yarn of different thicknesses. Adjust the hook size according to the thickness of the yarn selected. Also consider the size of the safety eyes if you decide to use them.**

I hope you enjoy designing this pattern for yourself as much as I did. 🌿✨

### Materials:

- 100% Mercerized Cotton thread (Eulali brand), average thickness approximately 1mm, with 1.5mm hook

Colors for Elyndra: Flesh, Tobacco, Citrus

Green, and Tangerine Colors for Lunithiel:

Flesh, Tobacco, Sky Blue, and Straw (Yellow).

- Super fine thread (sewing thread) in black just for embroidering the eyes.
- 14 inches of 20 gauge wire
- Wool Needle
- Scissors
- Time marker
- Pins
- Stuffing for amigurumis
- Glue

<https://youtu.be/tVD10esWaYM?t=53>

### Abbreviations:

- R: Round
- ch: chain stitch
- MR: Magic ring
- sc: single crochet
- dec: decrease (close 2 sc together)
- inc: Increase (2sc in 1 stitch)
- dc: double crochet
- hdc: half double crochet
- ss: Slip stitch
- FLO: Front Loop Only (take only the front strand)
- BLO: Back Loop Only (take only the back strand)



Copyright

This pattern is intended for personal use only. Reproduction, translation or distribution in any form is not permitted.

R4-16: 6sc

Make a perfect closure using a wool needle  
wool needle

## Arms (x2)

Use flesh-colored yarn

R1: MR 6sc

R2: 6sc

R3: 2sc, 1 bobble stitch: 3dc in the same base and closed together, 3sc (6)

<https://youtu.be/tVD10esWaYM?t=442>



It is not necessary to fill the arms because they are very thin and then we will place wire

Let me explain what a perfect closure is:

- After cutting the thread, pull it out and attach a tapestry needle.
- Skip one stitch and, in the next stitch, pass the tapestry needle under the chain that forms above the stitch.
- Then insert the tapestry needle just above the last stitch you made.

Whenever a perfect close is mentioned, follow these steps exactly.

<https://youtu.be/tVD10esWaYM?t=723>



Copyright

This pattern is intended for personal use only. Reproduction, translation or distribution in any form is not permitted.



## Legs (x2)

<https://youtu.be/tVD10esWaYM?t=842>

Start using Sky Blue yarn

R1: MR 6sc

R2: (2sc, 1inc)x2 (8)

R3-4: 8sc

Change to flesh-colored yarn in the last sc of R4

Every time you need to make a color change, follow these steps:

- Finish the last stitch of the round and pull out the yarn over a little.
- Insert the hook through the center of the stitch, as shown in the picture.
- Draw the new color and start the next round.
- Before finishing this round, pull the strand of the previous color and secure it to the new color with a simple knot.
- Leave the strands inside the piece so that they become part of the filling.

I won't go into this explanation any further.

From now on, whenever you make a color change, do it this way with the corresponding colors.

<https://youtu.be/tVD10esWaYM?t=926>



R5: BLO 8ss

R6: BLO 8sc

<https://youtu.be/tVD10esWaYM?t=962>

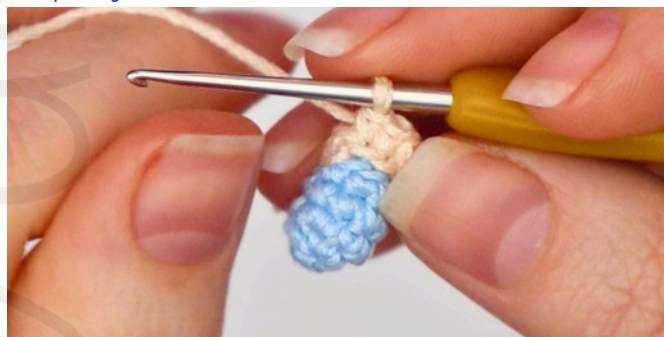

R7: (2sc, 1dec)x2 (6)

R8-22: 6sc

<https://youtu.be/tVD10esWaYM?t=1099>

Next, we will join the legs at R23. When the first leg is finished, cut the thread and make a perfect fastener.



Copyright

It is necessary to determine which will be the center side of each leg where we will join; to do this, use markers. Although I give you exactly the stitches to make in this round, the most important thing is that at the beginning of the round you knit as many stitches as you need until you reach your marker, and then finish the round with the remaining stitches of that leg. Place the leg in front of you leaving the color changes always to the back, as shown in the image, determine the center. Please watch the video for better understanding.

R23: 3sc in the second leg I make, 2ch of separation, 6sc in the other leg, 2sc in the 2ch, 3sc in the remaining stitches of the leg in which I start this R (16)

<https://youtu.be/tVD10esWaYM?t=1162>



R24-25: 16sc Change to Sky Blue yarn in the last sc of R6

Note: Do not cut the flesh-colored strand, as we will use it again later.

<https://youtu.be/tVD10esWaYM?t=1368>



R26: BLO 16ss  
R27: BLO 16sc  
R28-30: 16sc

Change to flesh or skin color in the last sc of R30



Copyright



You can change the color now or later, as you prefer. However, you can now cut the sky blue strand and continue with the skirt.



## Skirt

Using Sky Blue yarn Work on the front strands of the stitches knitted in sky blue that we left unused earlier. Start from the back of the body, trying to position yourself as centered as possible. This will help the closure of the rounds to be discreet and not visible on the front of the amigurumi.

R1: Pull up a loop, 2ch, in the same loop start (3 hdc, 1 hdc inc)x4, 1ss in the first hdc of this round. (20)

R2: 2ch, 20hdc, 1ss (20)

R3: 2ch, (4hdc, 1 hdc inc)x4, 1 s (24)

R4: 2ch, 24hdc, 1ss (24)

R5: 2ch, (5hdc, 1 hdc inc)x4, 1ss (28)

R6: 2ch, 28hdc, 1ss (28)

R7: 2ch, (3hdc, 1 hdc inc) x7, 1ss (35)

R8: 2ch, 35hdc, 1ss (35)

R9: (1ch, 1ss) x35

Finish with 1c, cut the yarn and bring it to the back, bringing it right to the base of the slipped stitch you closed the previous round with. Then, on the back of the fabric, secure the yarn and hide it between the stitches for a neat finish.

<https://youtu.be/tVD10esWaYM?t=1455>

<https://youtu.be/tVD10esWaYM?t=1778>

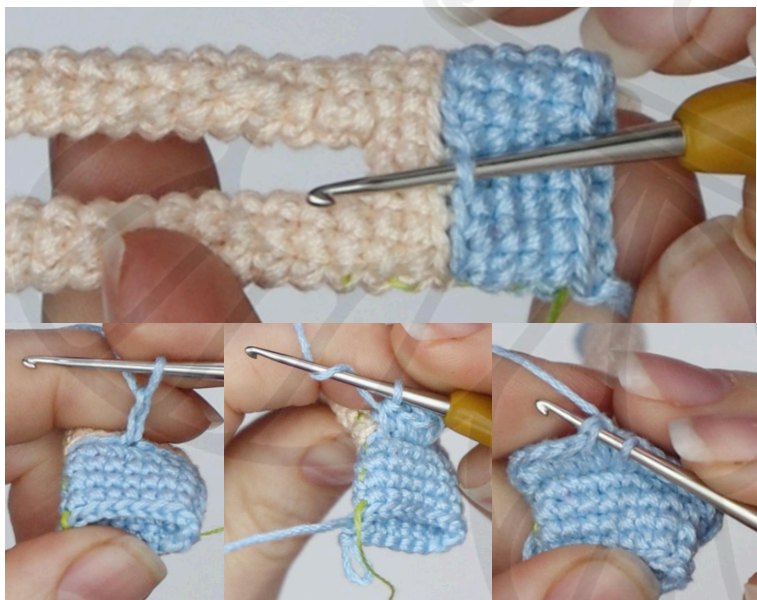

Copyright

This pattern is intended for personal use only. Reproduction, translation or distribution in any form is not permitted.

Let's continue with the body. Remember to change to flesh-colored yarn in the last sc of R30.



R31: BLO 3ss joining 1 arm, 5ss only on the body, 3ss joining the other arm, 5ss only on the body (16)

Note: Make sure that both arms are aligned at the sides of the body, always with the bobble point (the finger) facing the front of the amigurumi. If necessary, adjust the position of the stitches to achieve the correct alignment. This is completely normal, as each person knits differently, which can cause the distribution of the stitches to vary slightly. Modifying this round will not affect the rest of the pattern, as the adjustment is only to ensure the proper position of the arms.

<https://youtu.be/tVD10esWaYM?t=1865>



Note: To join each arm with slip stitches, insert the hook from the inside to the outside of the body. This will ensure a cleaner and more uniform join, maintaining the aesthetics of the amigurumi.



Note: The reason we indicate to end R31 with 16 stitches is because the slipped joining stitches are not counted in the total count. We only consider the body stitches and the 3 stitches left free on each arm.

<https://youtu.be/tVD10esWaYM?t=2110>



Copyright



R32: 3sc on one arm, BLO  
5sc, 3sc on the other arm,  
BLO 5sc (16)

<https://youtu.be/tVD10esWaYM?t=2134>

Prepare the wire to articulate each leg and arms.  
If you want to use exactly this wire that you see in  
the image, I share the link to our Amazon favorites  
where you will find it.

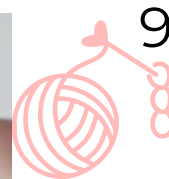

🛒Our Amazon Favorites: <https://www.amazon.com/shop/gretawings>

You will need approximately 2 wires measuring 11cm each for the arms and 2 wires measuring 13cm for the legs. To secure them, slightly bend each end of the wire, which will help prevent it from slipping out of place. If you want extra support, you can wrap them with tape, but keep in mind that the arms are extremely thin, so the wire needs to be fed precisely to the ends without adding too much thickness.

Note: You may want to use an additional tool, such as a wooden toothpick, to ensure there is enough space before inserting the wires. This will help you clear any wires stuck inside the limbs and make it easier to insert the wire without difficulty. Next, fill only the center of the body.

Once you have inserted the wires, carefully bend them together at the neck area. Then, use a flesh-colored thread to secure them tightly, wrapping several times until they are secure. This will help keep the structure stable and in place within the amigurumi.

<https://youtu.be/tVD10esWaYM?t=2244>

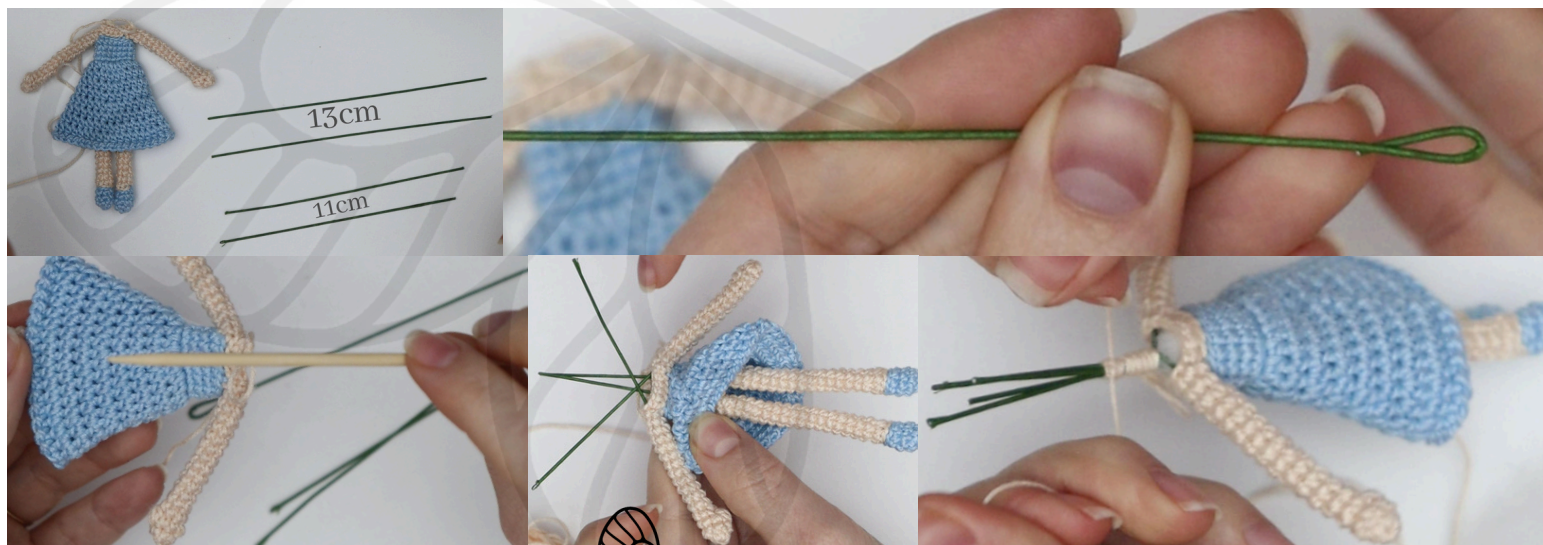

Copyright

This pattern is intended for personal use only. Reproduction, translation or distribution in any form is not permitted.



R33: 8dec (8)

R34-35: 8sc

R36: FLO 8inc (16)

<https://youtu.be/tVD10esWaYM?t=2588>



After completing R36, it is best to detail the straps before continuing with the head. This will make it easier to handle the amigurumi and allow you to work more accurately on the details, ensuring a better finish.

## Braces

Use sky blue thread To begin the detail of the straps, start at the back of the body, working over the front strands that we left free in sky blue. Locate the central strand of the 5 available and pull out the loop to start.

Start at next st, 2ss, 10ch, 5ss on front of body, 10ch, 2ss.

Cut the thread leaving enough length to make a perfect closure with the help of a tapestry needle. Make sure to carefully thread the thread through the final stitches to achieve a clean and neat finish, maintaining the aesthetics of the amigurumi.

<https://youtu.be/tVD10esWaYM?t=2716>

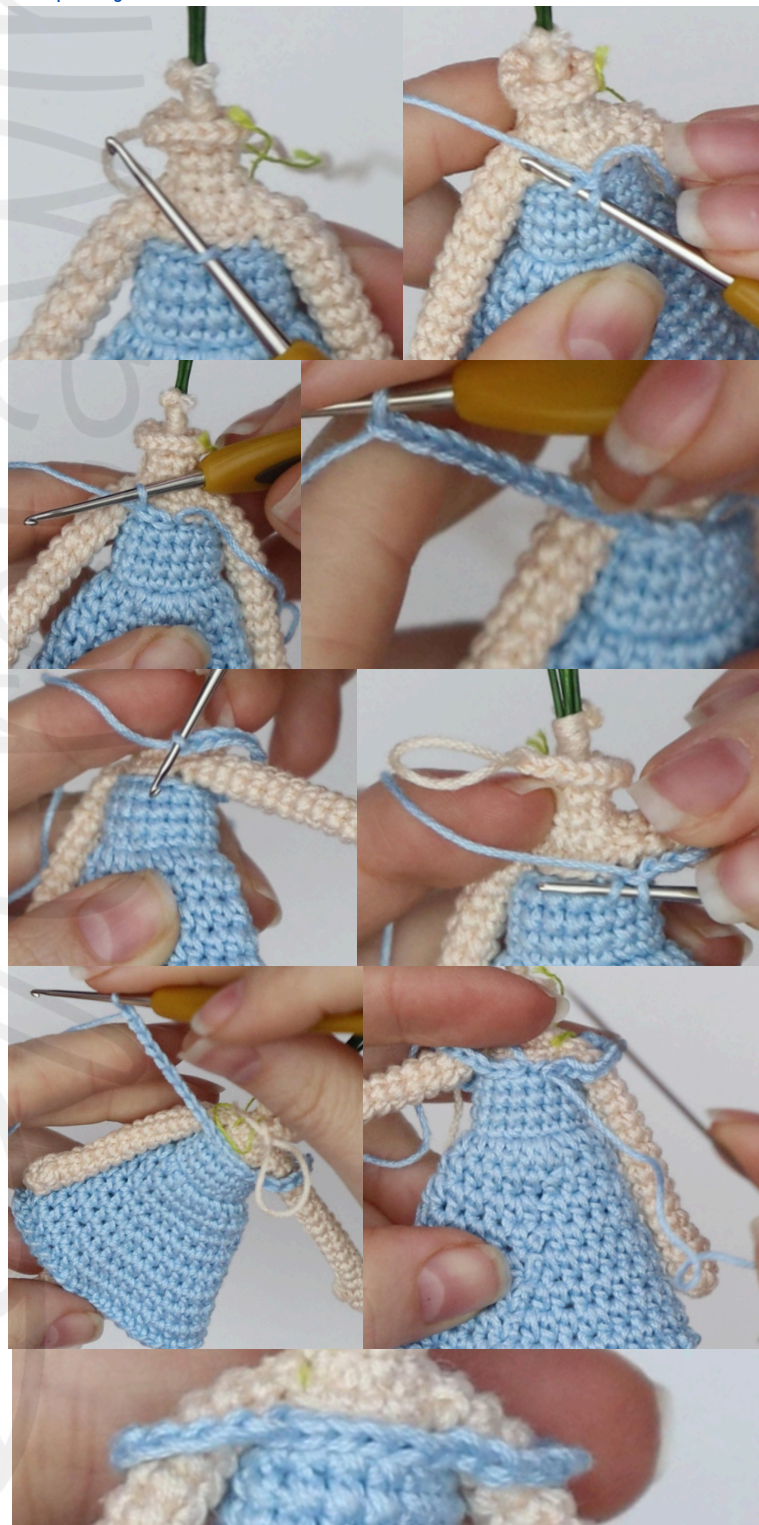

Copyright

This pattern is intended for personal use only. Reproduction, translation or distribution in any form is not permitted.





<https://youtu.be/tVD10esWaYM?t=3341>

Continue with the head

<https://youtu.be/tVD10esWaYM?t=2988>

R37: (1 sc, 1 inc) x8 (24)

R38: (2 sc, 1 inc) x8 (32)

R39: 1 sc, 1 inc, (3 sc, 1 inc) x7, 2 sc (40)

R40-48: 40 sc (40)

R49: (3 sc, 1 dec) x8 (32)

R50: (2 sc, 1 dec) x8 (24)

When you're done with R50, bend or cut off any excess wire as needed. Then, add filler to the head only, making sure to keep the wires as centered as possible to ensure a firm, balanced structure. If needed, you can add a little more filler at the end of the last round for a better finish.



<https://youtu.be/tVD10esWaYM?t=3180>

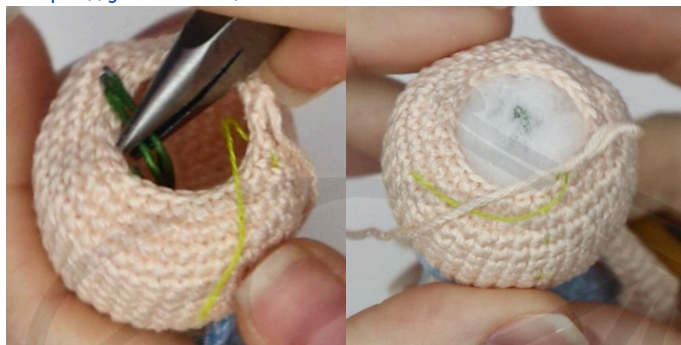

R51: (1 sc, 1 dec) x8 (16)

R52: 8 dec (8)

<https://youtu.be/tVD10esWaYM?t=3290>

Cut the thread leaving enough length to close the piece using a tapestry needle. Make sure to carefully thread the thread through the end stitches to get a tight, neat closure.

## Hair

Use straw colored thread (Yellow)

Start with a slip knot

R1: 32ch, in the 3rd start BLO 30hdc (30)

<https://youtu.be/UGmKf3XHFtQ?t=60>

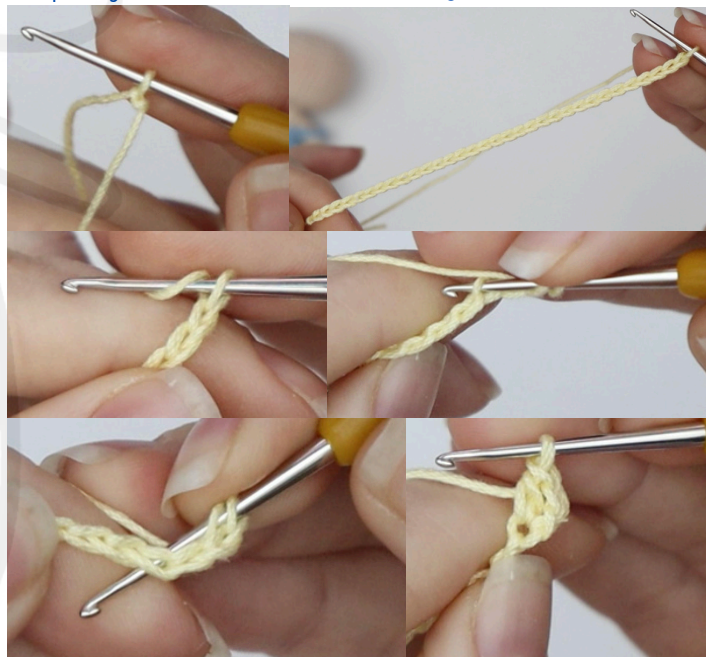

Copyright



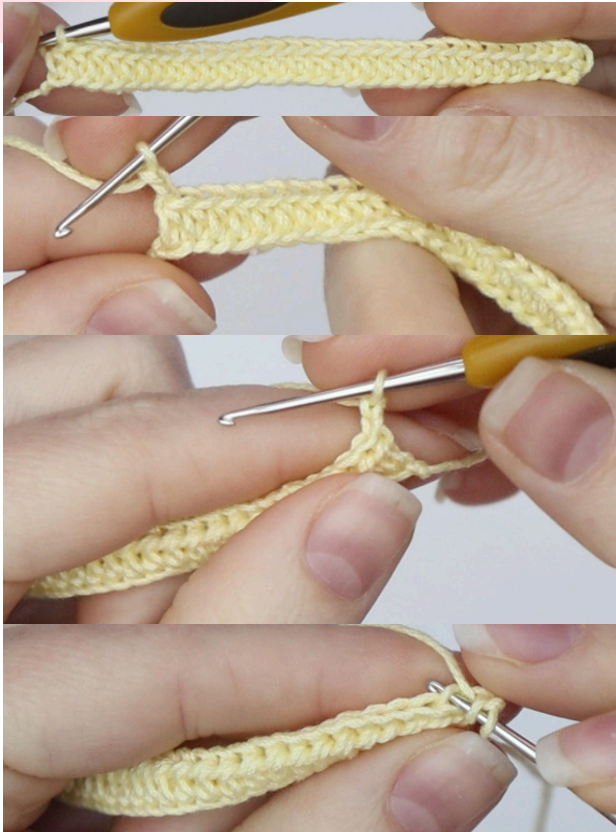

R2-16: 2ch, turn, BLO 30hdc (30)

Make 1ch to secure the weave, then cut the strand leaving enough length to close and shape the hair later.

<https://youtu.be/UGmKf3XHFiQ?t=225>

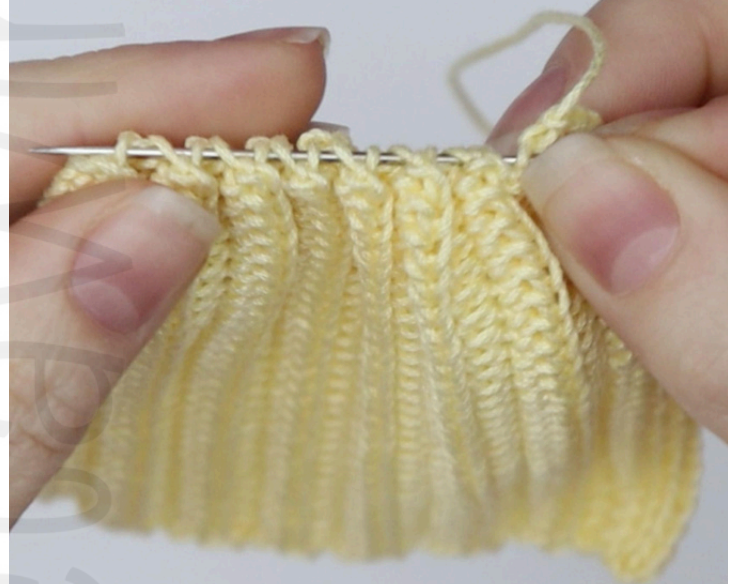
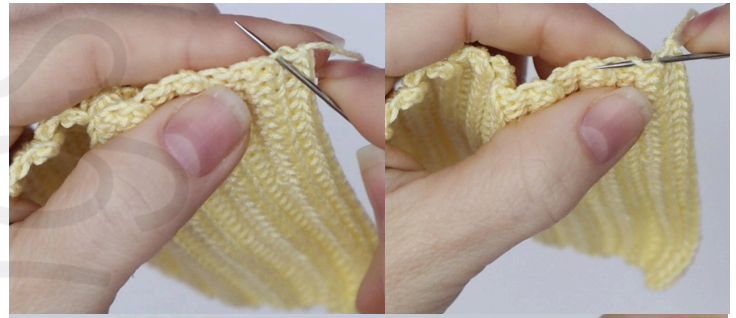

Copyright

This pattern is intended for personal use only. Reproduction, translation or distribution in any form is not permitted.



## Diadem

Use sky blue thread

Start with a slip knot

(6ch, in the 2nd st start BLO 1sc, 1ss)x14

Close with a common knot, joining the strands at both ends to firmly secure the weave, and then hide the remaining strands.

<https://youtu.be/UGmKf3XHFiQ?t=373>

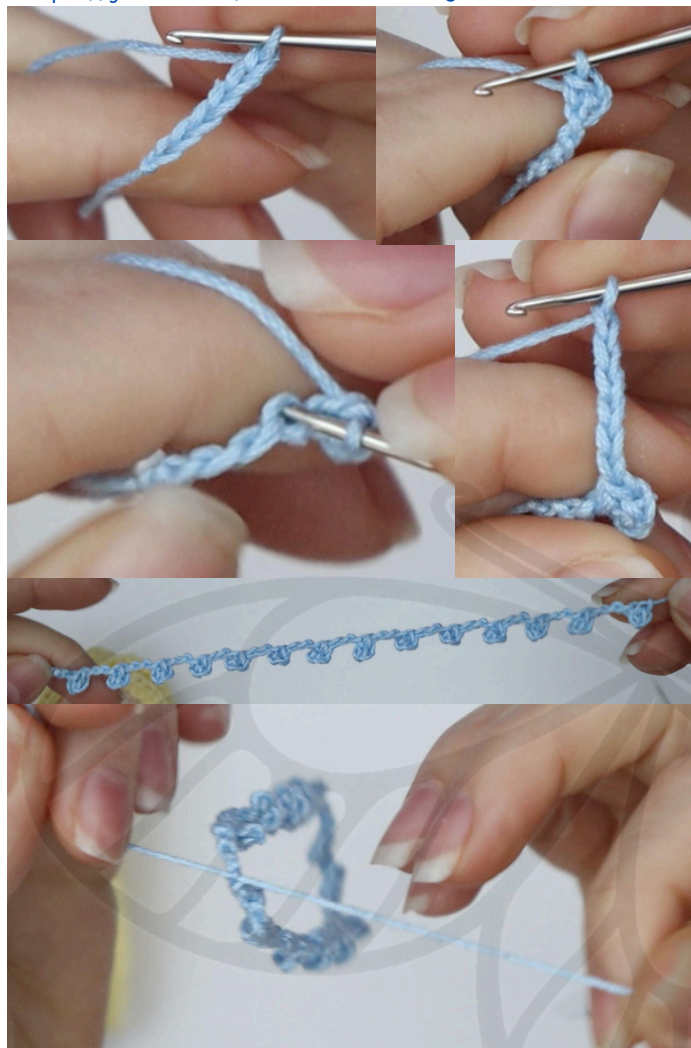

## Right Ear

Use flesh-colored thread

Note: At the beginning and end of each ear, it is important to leave a long strand, as this will be used later to attach the ear to the head securely and neatly.

When you finish each ear, thread the final strand through the magic ring, then tighten it tightly to close it completely. This will ensure a well-defined shape and prevent it from unraveling over time.

MR: 1sc, 1hdc, 2dc, 3ch, BLO 1ss at the base of the 3rd ch, 2ch, 1ss in the MR.

<https://youtu.be/UGmKf3XHFiQ?t=562>



## Left Ear

Use flesh-colored thread

<https://youtu.be/UGmKf3XHFiQ?t=690>

MR: 6ch, in the 3rd ch from the hook (BLO) 1ss, 2dc, 1hdc, 1sc, 1ss in the MR.



Copyright

## Detail of the dress

Use light tobacco colored thread. At the beginning and at the end it is important to leave a long strand, since this will be used later to join the piece to the body.  
Start with 1 slip knot.

11ch, in the 2nd begin BLO 1sc, 1ss, 8ch  
When finished, break the thread and use the last chain to secure the fabric, preventing it from coming undone.

<https://youtu.be/UGmKf3XHFiQ?t=808>



Embroider the eyes using double-stranded black sewing thread.  
First, determine the exact placement before you begin. To do this, place the black pins between R41 and R42, making sure to leave a gap of 9 stitches between them.  
Next, place the red pins between R42 and R43, forming a V with the bottom pin of each eye. In the center of the face, leave a gap of 6 points between both eyes.  
If you need more clarity on the process, please refer to the reference video for better understanding.

<https://youtu.be/UGmKf3XHFiQ?t=879>

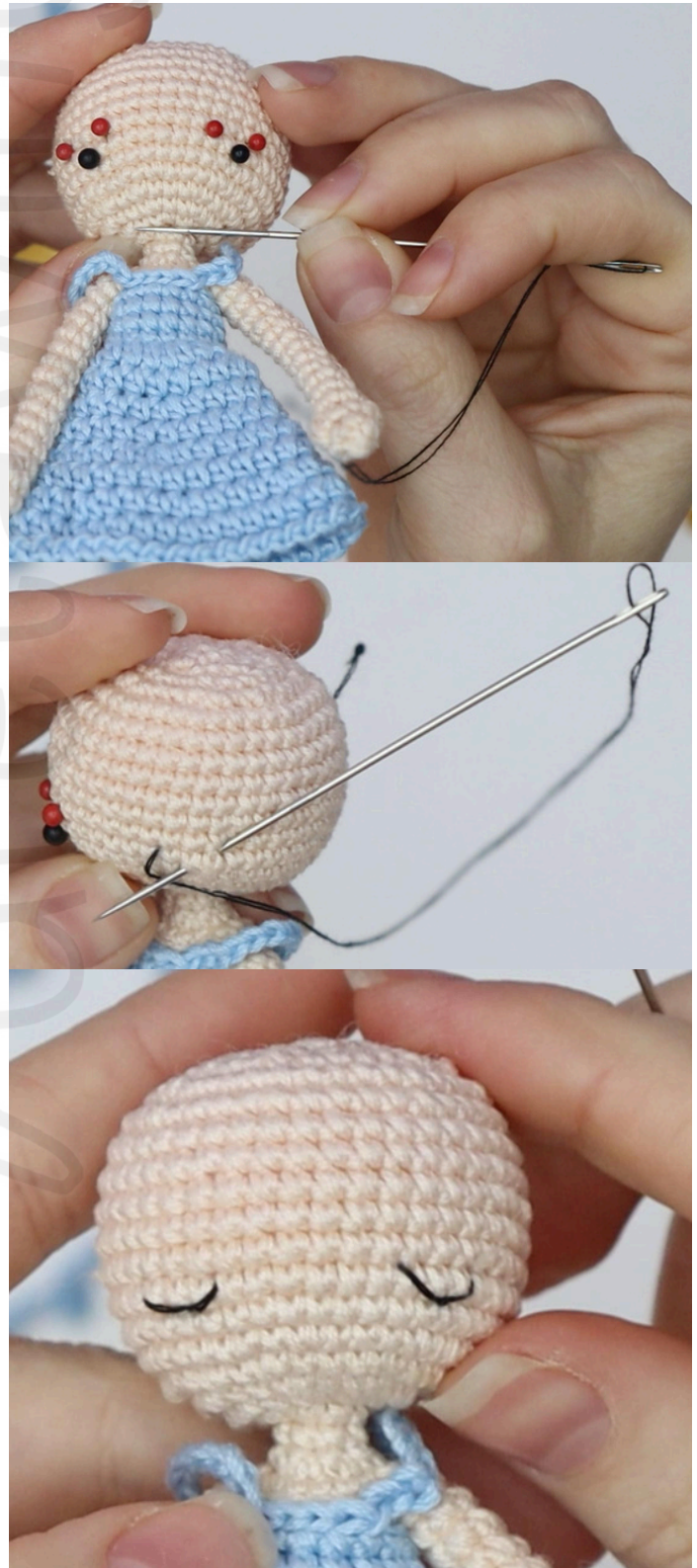

Copyright



Using a long strand of light tobacco-colored thread, make the detail on the leg using a tapestry needle. First, pass the strand from one side to the other, making sure to form an X at the front, another at the back, and another at the front.

Once you've completed your design, bring the strands towards the back of the leg, secure them with a regular knot to keep them in place, and finally, hide them inside the leg for a neat, clean finish.

<https://youtu.be/UGmKf3XHFiQ?t=1217>



Position the hair as you like, distributing it evenly to achieve the desired style. Once you are happy with the position, secure it with glue, making sure to apply it carefully to both the front and back.

<https://youtu.be/UGmKf3XHFiQ?t=1337>



Place the ears on top of your hair, aligning them at eye level. Bring each strand down to the lower part of your hair on your head, secure them firmly and hide them inside the weave for a neat finish. If you prefer, you can also secure them with glue.

<https://youtu.be/UGmKf3XHFiQ?t=1436>



Copyright



For a neat finish, it's important to arrange the headband carefully. I suggest starting at the front center, making sure it's aligned properly. Then, carefully adjust each of the remaining sections to maintain symmetry. Secure it by applying just a dab of glue to each tip, avoiding excess for a clean, natural look.

Also, secure the detail to the waist by tying a regular knot at the back to secure it firmly, and hide the remaining strands inside the body. For added stability, apply a small amount of glue to the tip of the detail, securing it to the dress carefully so as not to overdo it.

Finally, for a better visual effect, attach the straps to the arms with glue, making sure they fall gently for a delicate and elegant finish.

<https://youtu.be/UGmKf3XHFiQ?t=1673>



Copyright

This pattern is intended for personal use only. Reproduction, translation or distribution in any form is not permitted.



Congratulations! You have completed your amigurumi.

If you have enjoyed our pattern and decide to share your final work on your social networks, don't forget to tag us so we can admire your result.

Please remember that this is a paid pattern that I have put a lot of time and love into. I ask you please, out of respect for our project, not to share it in groups or on the web, as it does us a great disservice. Even if you have purchased the pattern, please remember that you are purchasing the pattern and not the copyright, which belongs to GretaWings. Thank you! If you have not purchased, you are purchasing the pattern not the copyright and the rights to it belong to GretaWings, thank you

