









Copyright: This pattern is for personal use only. Its copying, translation or distribution in any form is prohibited.

Contact information

If you have any questions when making this pattern, do not hesitate to contact me.

Also, I would love to see your finished amigurumi

-  linetr2011@gmail.com
-  GretaWings <https://www.instagram.com/gretawings/>
-  GretaWings https://www.facebook.com/grettawings/?ref=pages_you_manage
-  GretaWings <https://www.youtube.com/channel/UCz8UB400yzrx6XS9Ncvy7nA>
-  Greta Wings in English https://www.youtube.com/channel/UCr4xjdD89uaRXwKnJb6u7_g
-  GretaWings <https://gretawings.com/>

Copyright

This pattern is for personal use only. Its copying, translation or distribution in any form is prohibited.

You can sell the final result of your amigurumi in the way you choose. If you sell your finished item online please provide a link to our website in your description and that way you also support our project

Important note:

This amigurumi is worked with well-adjusted stitches and for the most part in a spiral shape, do not close each round unless I tell you to, you will have to be careful and always mark the beginning of each round. Please read the entire pattern before beginning.

In the description, before buying this pattern, I told you that we have a tutorial on our channel to make this amigurumi.

You can enter the links that I share attached to each image if you have any questions.

If you detect any errors in this pattern please contact me.





This base body for LoL Dolls measures approximately 9 inches (23cm)

Materials:

- Sinfonia yarn 100% Mercerized Cotton, measures approximately 3mm thick and has 6 strands. Colors: Flesh or Leather 890, Mexican Rose 825. With 2.5mm Hook
- Eulali yarn 100% Mercerized Cotton, measures approximately 1mm thick and has 4 strands. Colors: White C-1, Black C-99, Light Tobacco C-25. With 1.60mm Hook
- Hila La Abuelita 100% Mercerized Cotton, measures approximately 1mm thick and has 6 strands. Color: Pink (for the mouth) With 1.60mm Hook
- Aguja Lana
- temporary bookmark
- Scissors
- stuffing for amigurumi
- pins
- Silicone tube, 1cm diameter and 12cm long
- hot silicone glue

<https://youtu.be/lb40rOgEJys?list=TLPQMTAwMzlwMjM3qH4zog5ZLQ&t=170>

Note: You can use this same pattern to make this amigurumi larger or smaller using a thicker or smaller thread and depending on this thread will be the hook number. In the same way, you will choose, you must take into account the size of your eyes.

I hope you enjoy this pattern as much as I do.
by designing it for you.

Abbreviations:

R: Ronda
 ch: chain
 MR: Magic Ring
 ss: slip stitches
 sc: single crochet
 dec: decrease (close 2 sc together)
 inc: increase (2sc in 1stiche)
 triple inc: increase (3sc in 1stiche)
 hdc: half double crochet



Arms (x2)

<https://youtu.be/lb40rQgEJys>

Use flesh or skin color yarn

R1: MR 6sc

R2: (1sc, 1inc)x3 (9)

R3: 9sc

R4: 4sc, (1speck point: 4hdc in the same place and closed together), 4sc (9)

<https://youtu.be/lb40rQgEJys>



R5: 9sc

R6: FLO (2sc, 1inc)x3 (12)

R7-9: 12sc

R10: (4sc, 1dec)x2 (10)

R11-16: 10sc

Cut the strand, no length is needed, these arms will join the body seamlessly. Fill, just enough for you to take your form, but not too much if you want them flexible

<https://youtu.be/lb40rQgEJys>



Legs (x2)

Start using flesh or skin color yarn

R1: 4ch, in the 2nd start, (2sc, 1triple inc)x2 (10)

<https://youtu.be/lb40rQgEJys>



R2: (2sc, 3inc)x2 (16)

R3: 3sc, 4inc, 4sc, 4inc, 1sc (24)

R4: BLO 24sc

R5-6: 24sc

Note: When finishing the R6 it is necessary to fill the feet with silicone or recycle plastic, in this way the result is flatter. In case of using melted silicone, it is advisable to make both legs up to R6 and fill them both at the same time. (see link for better understanding)

<https://youtu.be/lb40rQgEJys>





R7: 4sc, 4dec, 6sc, 2dec, 2sc (18)
 R8-14: 18sc
 R15: 4sc, FLO 4sc, 4sc, 3dec (15)
 R16: 5sc, 2inc, 5sc, 3inc (20)
 R17-23: 20sc



Note: At the end of the first leg, cut the yarn over, to finish the second one, in the last single crochet of Round 23 change to Mexican pink thread and do not cut the yarn over to continue with the next round and join the legs.

<https://youtu.be/lb40rQgEJys>



R24: La Union using Mexican pink color yarn, 4sc, 2ch, 20sc on the other free leg, 2sc in the 2ch, 16sc on the starting leg (44)

Note: Both legs must be straight, see the video in case the same points do not make it.

<https://youtu.be/lb40rQgEJys>





R25-27: 44sc

R28: (9sc, 1dec)x4 (40)

R29-30: 40sc

R31: (3sc, 1dec)x8 (32)

R32: 32sc Change to flesh or skin colored yarn in the last single crochet of this round.

<https://youtu.be/lb40rQgEJys>



R33: (6sc, 1dec)x4 (28)

R34-36: 28sc

R37: Union of Arms 12sc, 10sc in one arm, 14sc, 10sc in another arm, 2sc (48)

Note: It is necessary that each little arm is facing forward, if it does not look like this, please watch the video.

<https://youtu.be/lb40rQgEJys>



Note: With a wool needle and only 2 threads of the same yarn close the hole that remains under each arm (see video)

<https://youtu.be/lb40rQgEJys>



R38: (2sc, 1dec)x12 (36)

R39: (1sc, 1dec)x12 (24)

R40: (1sc, 1dec)x8 (16)

<https://youtu.be/lb40rQgEJys>



Note: Fill each shoulder very well, but in the center keep it with little filling



R41-44: 16sc



R45: FLO 16inc (32)

<https://youtu.be/lb40rQgEJys>



R46: (3sc, 1inc)x8 (40)

R47: (4sc, 1inc)x8 (48)

R48: (7sc, 1inc)x6 (54)

R49: 4sc, 1inc, (8sc, 1inc)x5, 4sc (60)

R50: (9sc, 1inc)x6 (66)

R51: 5sc, 1inc, (10sc, 1inc)x5, 5sc (72)

R52-59: 72sc

R60: (3sc, 1inc)x18 (90)

R61-66: 90sc



<https://youtu.be/lb40rQgEJys>

Note: Using something sharp, create a hole to insert the silicone tube. Leave it or place it again later before completely closing the head

R67: (8sc, 1dec)x9 (81)

R68-69: 81sc

R70: (7sc, 1dec)x9 (72)

R71-72: 72sc

R73: (10sc, 1dec)x6 (66)

R74: 66sc

R75: (9sc, 1dec)x6 (60)

<https://youtu.be/lb40rQgEJys>



Note: Place padding in the neck around the silicone or support you have chosen.



R76: 4sc, 1dec, (8sc, 1dec)x5, 4sc (54)

R77: (7sc, 1dec)x6 (48)

R78: (6sc, 1dec)x6 (42)

R79: (5sc, 1dec)x6 (36)



<https://youtu.be/lb40rQgEJys>

Note: Placing melted silicone around the silicone tube and a little on the bottom of the head will give more support. Fill the head although before closing it is necessary to place more and more filling. Also cut off excess silicone.

<https://youtu.be/lb40rQgEJys>



<https://youtu.be/lb40rQgEJys>

R80: (4sc, 1dec)x6 (30)

R81: (3sc, 1dec)x6 (24)

R82: (2sc, 1dec)x6 (18)

R83: (1sc, 1dec)x6 (12)

R84: 12sc

Knitting needle closure (see video)

<https://youtu.be/lb40rQgEJys>



Ears (x2)

Use flesh or skin color yarn

Leave a long strand at the beginning before making the magic ring

R1: MR 5sc

R2: turn, 1sc, 3hdc inc, 1sc (8)

Leave a long strand for joining the head.

<https://youtu.be/lb40rQgEJys>



Eyes (x2)

<https://youtu.be/lb40rQgEJys>

Eulali yarn (1mm thick yarn)

Hook 1.60mm

Start using black color yarn

R1: MR 8sc

R2: 8inc (16)

R3: (1sc, 1inc)x8 (24)

Note: Do not cut the yarn, make 1 chain as a fastener for the moment, then more rounds will be done with this yarn.

R4: Using Light Tobacco color yarn, begin in the 3rd slipped stitch of R3.

BLO pulls out a loop, in the next slip stitch begins, 15ss. Cut the yarn over and pull it back towards the back at the same stitch as the last slipped stitch.

R5: Continue using light tobacco yarn, Start at the 2nd slip stitch of R4.

BLO pulls out a loop, in the next slipped stitch begin, 2sc, (1hdc, 1hdc inc)x3, 1hdc, 2sc, 1ss. Cut the yarn over and pull it back towards the back at the same stitch as the last slipped stitch.

R6: Undo the chain that was made at the end of R3.

BLO 27ss

Note: Do not cut the yarn, make 1 chain as a fastener for the moment, then more rounds will be done with this yarn.

Mouth

La Abuelita yarn 1mm thick, hook

1.60mm

MR 2sc, 3hdc, 5sc, 1ch, 1hdc, 1ch, 1ss, 1ch,

1hdc, 1ch, 3sc

Close with a wool needle and leave the long tail to join the face later.

<https://youtu.be/lb40rQgEJys>



R7: Using White color yarn, begin at the 5th slipped stitch of R6.
 BLO pulls out a loop, in the next slip stitch begins, 13ss. Cut the yarn over and pull it back towards the back at the same stitch as the last slipped stitch.

R8: Continue using white color yarn, Start at the 1st slipped stitch of R7.
 BLO pulls out a loop, beginning in the next slipped stitch, 2sc, (1hdc, 1hdc inc)x3, 2sc, 1ss. Cut the yarn over and pull it back towards the back at the same stitch as the last slipped stitch.

R9: Undo the chain that was made at the end of R3.
 BLO 30ss
 Cut the thread leaving enough to close using a wool needle and also for the union with the face, embroidery of eyebrows and eyelashes.
 (ver enlace)

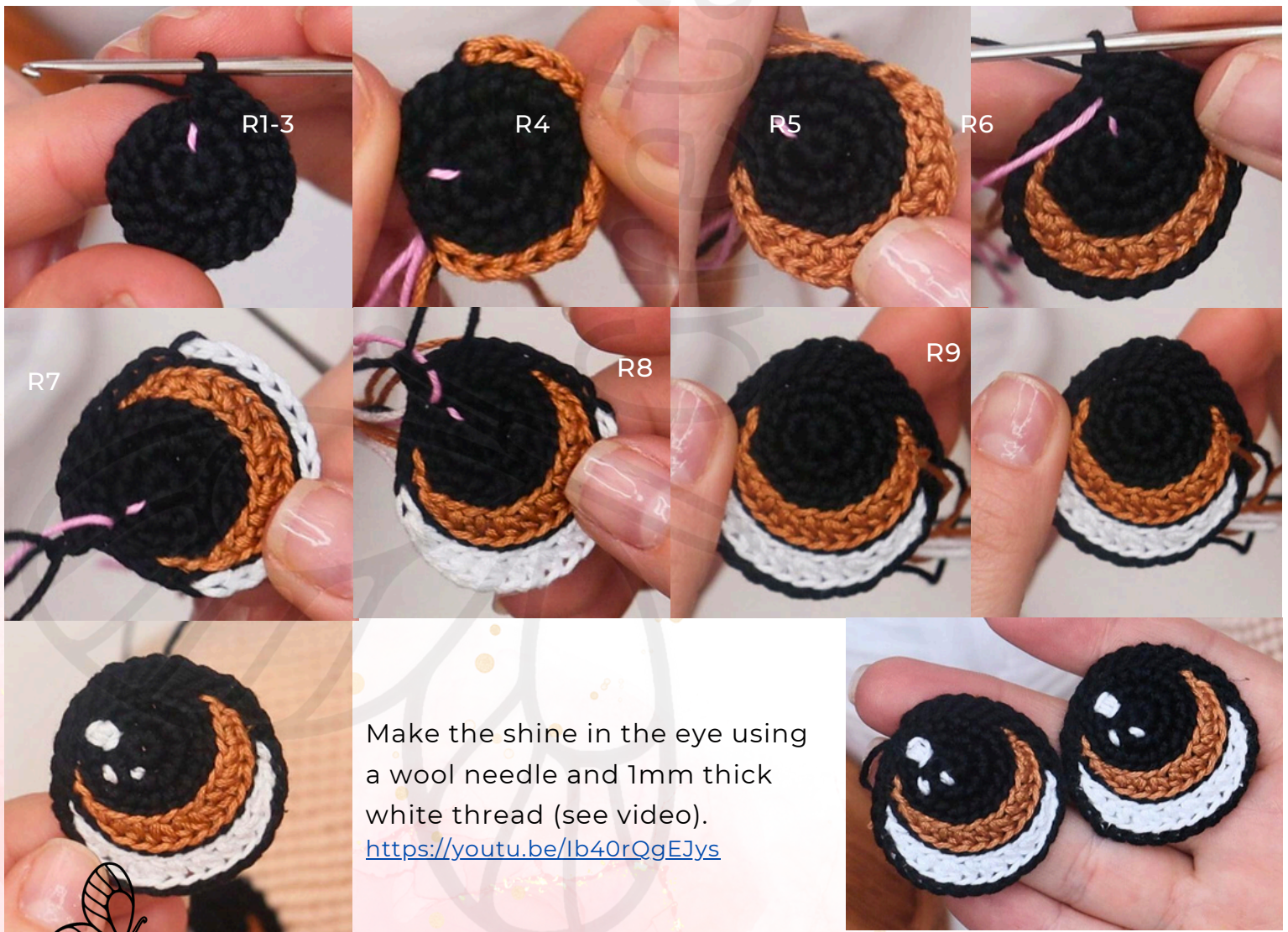

Note: To carry out the union of all the details of the face, Ears, Eyes, Mouth, Nose and embroidery of eyebrows and eyelashes, please see the link to the video that we share if the images are not enough.

Ears <https://youtu.be/lb40rQgEJys>

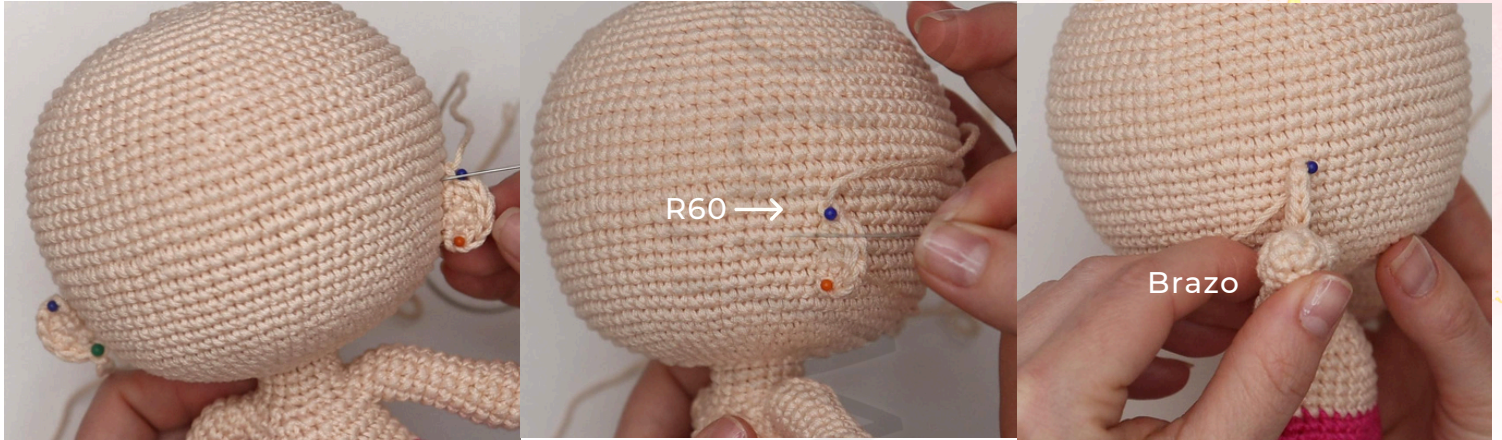

Eyes <https://youtu.be/lb40rQgEJys>



Mouth <https://youtu.be/lb40rQgEJys>



Nose <https://youtu.be/lb40rQgEJys>



https://youtu.be/G7GR0_v1Csl?t=2219



Congratulations!!
has finished the Base Corps for LoL



If you have enjoyed our pattern and you publish your final work on your networks, do not forget to tag me so I can see the result

Remember this is a payment pattern, to which I have dedicated a lot of my time and love. I ask you in favor and out of respect for our project that you do not distribute it in groups or on the web because it harms us enormously and you would be committing a crime despite having bought it, you are buying the pattern, not the copyright and the rights to it same we belong to GretaWings, thanks